

NATIONAL REGISTER OF HISTORIC PLACES  
INVENTORY - NOMINATION FORM

(Type all entries - complete applicable sections)

STATE: North Carolina	
COUNTY: Hertford	
FOR NPS USE ONLY	
ENTRY NUMBER	DATE

1. NAME

COMMON:  
John Wheeler House

AND/OR HISTORIC:

2. LOCATION

STREET AND NUMBER:  
103 East Broad Street

CITY OR TOWN:  
Murfreesboro

STATE:  
North Carolina

CODE 37	COUNTY: Hertford	CODE 091
------------	---------------------	-------------

3. CLASSIFICATION

CATEGORY (Check One)	OWNERSHIP	STATUS	ACCESSIBLE TO THE PUBLIC
<input type="checkbox"/> District <input checked="" type="checkbox"/> Building <input type="checkbox"/> Site <input type="checkbox"/> Structure <input type="checkbox"/> Object	<input type="checkbox"/> Public <input checked="" type="checkbox"/> Private <input type="checkbox"/> Both	Public Acquisition: <input type="checkbox"/> In Process <input type="checkbox"/> Being Considered	<input type="checkbox"/> Occupied <input checked="" type="checkbox"/> Unoccupied <input type="checkbox"/> Preservation work in progress
PRESENT USE (Check One or More as Appropriate)			
<input type="checkbox"/> Agricultural <input type="checkbox"/> Commercial <input type="checkbox"/> Educational <input type="checkbox"/> Entertainment	<input type="checkbox"/> Government <input type="checkbox"/> Industrial <input type="checkbox"/> Military <input type="checkbox"/> Museum	<input type="checkbox"/> Park <input checked="" type="checkbox"/> Private Residence <input type="checkbox"/> Religious <input type="checkbox"/> Scientific	<input type="checkbox"/> Transportation <input type="checkbox"/> Other (Specify)
Yes: <input checked="" type="checkbox"/> Restricted <input type="checkbox"/> Unrestricted <input type="checkbox"/> No			

4. OWNER OF PROPERTY

OWNER'S NAME:  
Murfreesboro Historical Association, Inc.

STREET AND NUMBER:  
c/o Mr. E. Frank Stephenson, Jr., Chowan College

CITY OR TOWN:  
Murfreesboro

STATE:  
North Carolina

CODE:  
37

5. LOCATION OF LEGAL DESCRIPTION

COURTHOUSE, REGISTRY OF DEEDS, ETC:  
Hertford County Courthouse

STREET AND NUMBER:

CITY OR TOWN:  
Winton

STATE:  
North Carolina

CODE:  
37

6. REPRESENTATION IN EXISTING SURVEYS

TITLE OF SURVEY:

DATE OF SURVEY:  Federal  State  County  Local

DEPOSITORY FOR SURVEY RECORDS:

STREET AND NUMBER:

CITY OR TOWN:

STATE:

CODE:

SEE INSTRUCTIONS

STATE: North Carolina  
COUNTY: Hertford  
ENTRY NUMBER  
DATE  
FOR NPS USE ONLY

7. DESCRIPTION

CONDITION	(Check One)					
	<input type="checkbox"/> Excellent	<input checked="" type="checkbox"/> Good	<input type="checkbox"/> Fair	<input type="checkbox"/> Deteriorated	<input type="checkbox"/> Ruins	<input type="checkbox"/> Unexposed
	(Check One)			(Check One)		
	<input checked="" type="checkbox"/> Altered	<input type="checkbox"/> Unaltered	<input type="checkbox"/> Moved	<input checked="" type="checkbox"/> Original Site		

DESCRIBE THE PRESENT AND ORIGINAL (if known) PHYSICAL APPEARANCE

The Wheeler House is a two-story structure built of brick laid in Flemish bond. The south (front) facade is three bays wide with windows of nine-over-nine sash on the first story and six-over-nine on the second, both trimmed with jack arches. The main feature of the facade is a later two-story pedimented portico supported by four simple square columns and enclosed with scroll saw balustrades. The central entrance is framed by attenuated paneled pilasters, sidelights, and is surmounted by an elliptical fanlight. The house has a single interior chimney at each end. The gable roof has slightly splayed eaves and rests on a simple cornice ornamented with pierced dentils. The north (rear) facade is covered by a two-bay shed porch which connects the house to a separate outbuilding. This dependency is a single-story, two-bay, gable-roofed structure of brick laid in common bond. It has a box cornice and slightly splayed eaves.

The interior of the Wheeler House is a central passage plan with one room on either side. To the left of the hall is a large parlor which has been greatly altered. It retains traces of the original painted wallpaper applied directly to vertical sheathing. The hall is finished with board and batten above and below the chair rail. The right parlor has plaster above the chair rail which is not original. In this room is an enclosed stair which actually opens into the hall.

SEE INSTRUCTIONS

**B. SIGNIFICANCE**

PERIOD (Check One or More as Appropriate)

- |  |                                       |  |                                       |
|--|---------------------------------------|--|---------------------------------------|
| <input type="checkbox"/> Pre-Columbian | <input type="checkbox"/> 16th Century | <input type="checkbox"/> 18th Century            | <input type="checkbox"/> 20th Century |
| <input type="checkbox"/> 15th Century  | <input type="checkbox"/> 17th Century | <input checked="" type="checkbox"/> 19th Century |                                       |

SPECIFIC DATE(S) (If Applicable and Known)

AREAS OF SIGNIFICANCE (Check One or More as Appropriate)

- |  |   |   |  |
|--|---|---|--|
| <input type="checkbox"/> Aboriginal              | <input type="checkbox"/> Education              | <input checked="" type="checkbox"/> Political | <input type="checkbox"/> Urban Planning                            |
| <input type="checkbox"/> Prehistoric             | <input type="checkbox"/> Engineering            | <input type="checkbox"/> Religion/Philosophy  | <input checked="" type="checkbox"/> Other (Specify) <u>history</u> |
| <input type="checkbox"/> Historic                | <input type="checkbox"/> Industry               | <input type="checkbox"/> Science              | _____  |
| <input type="checkbox"/> Agriculture             | <input type="checkbox"/> Invention              | <input type="checkbox"/> Sculpture            | _____  |
| <input checked="" type="checkbox"/> Architecture | <input type="checkbox"/> Landscape Architecture | <input type="checkbox"/> Sociol/Humanitarian  | _____  |
| <input type="checkbox"/> Art                     | <input type="checkbox"/> Literature             | <input type="checkbox"/> Theater              | _____  |
| <input type="checkbox"/> Commerce                | <input type="checkbox"/> Military               | <input type="checkbox"/> Transportation       | _____  |
| <input type="checkbox"/> Communications          | <input type="checkbox"/> Music                  |   |  |
| <input type="checkbox"/> Conservation            |   |   |  |

STATEMENT OF SIGNIFICANCE

John Wheeler came to Murfreesboro in 1796 from Hope Plantation in Bertie County, where he was employed by the Stone family. He bought the brick house in the first decade of the nineteenth century soon after its completion. Wheeler became quite prominent in Hertford County. He served as the town postmaster and a trustee of both Murfreesboro and Hertford academies. In 1806, his son, John Hill Wheeler, was born in the house. The younger Wheeler served as superintendent of the United States Mint at Charlotte, and as the first United States minister to Nicaragua, and he wrote a history of his state. After the death of the elder Wheeler and his wife Sarah in 1832 and 1833, the house was transferred to their son, Dr. Samuel Jordan Wheeler who graduated from Union College in New York and later became an authority on the history of the Baptist Church in North Carolina. He also founded the Murfreesboro Citizen newspaper. His son, Samuel, Jr., sold the house in 1872 to Julian G. Moore who quickly resold it to Jesse J. Yeates, a United States Senator from North Carolina. Yeates sold the property within one month to James M. Trader. The Trader family retained the house for over eighty years. In 1969 it was donated to the Murfreesboro Historical Association by Mrs. Virginia Camp Smith for restoration and inclusion in the Murfreesboro Historic District.

Plans are presently underway to restore the Wheeler House as an interesting example of vernacular architecture of the Federal period in North Carolina.

SEE INSTRUCTIONS

9. MAJOR BIBLIOGRAPHICAL REFERENCES

Hertford County Records, Hertford County Courthouse, Winton, North Carolina, Office of the Register of Deeds. (Subgroups: Deeds, Wills, Estate Papers, Census Reports.)

Hertford County Records, State Department of Archives and History, Raleigh, North Carolina. (Subgroups: Deeds, Wills, Estate Papers, Census Reports.)

Parramore, Thomas C. The Ancient Maritime Village of Murfreesboro, 1787-1825. Murfreesboro, North Carolina: Johnson Publishing Company, 1969.

10. GEOGRAPHICAL DATA

LATITUDE AND LONGITUDE COORDINATES DEFINING A RECTANGLE LOCATING THE PROPERTY			LATITUDE AND LONGITUDE COORDINATES DEFINING THE CENTER POINT OF A PROPERTY OF LESS THAN TEN ACRES		
CORNER	LATITUDE	LONGITUDE	LATITUDE		LONGITUDE
	Degrees Minutes Seconds	Degrees Minutes Seconds	Degrees	Minutes	Seconds
NW	° ' "	° ' "	36°	26'	39"
NE	° ' "	° ' "	77°	05'	54"
SE	° ' "	° ' "			
SW	° ' "	° ' "			

APPROXIMATE ACREAGE OF NOMINATED PROPERTY: One-half acre.

LIST ALL STATES AND COUNTIES FOR PROPERTIES OVERLAPPING STATE OR COUNTY BOUNDARIES

STATE:	CODE	COUNTY	CODE

11. FORM PREPARED BY

NAME AND TITLE:  
John Wells, Survey Specialist; Sherry I. Penney, Survey Assistant

ORGANIZATION: State Department of Archives and History DATE: 10/5/70

STREET AND NUMBER:  
109 East Jones Street

CITY OR TOWN: Raleigh STATE: North Carolina CODE: 37

12. STATE LIAISON OFFICER CERTIFICATION

As the designated State Liaison Officer for the National Historic Preservation Act of 1966 (Public Law 89-665), I hereby nominate this property for inclusion in the National Register and certify that it has been evaluated according to the criteria and procedures set forth by the National Park Service. The recommended level of significance of this nomination is:

National  State  Local

Name Dr. H. G. Jones

Title Director, State Department of Archives and History

Date October 5, 1970

NATIONAL REGISTER VERIFICATION

I hereby certify that this property is included in the National Register.

Chief, Office of Archeology and Historic Preservation

Date \_\_\_\_\_

ATTEST:

Keeper of The National Register

Date \_\_\_\_\_

SEE INSTRUCTIONS

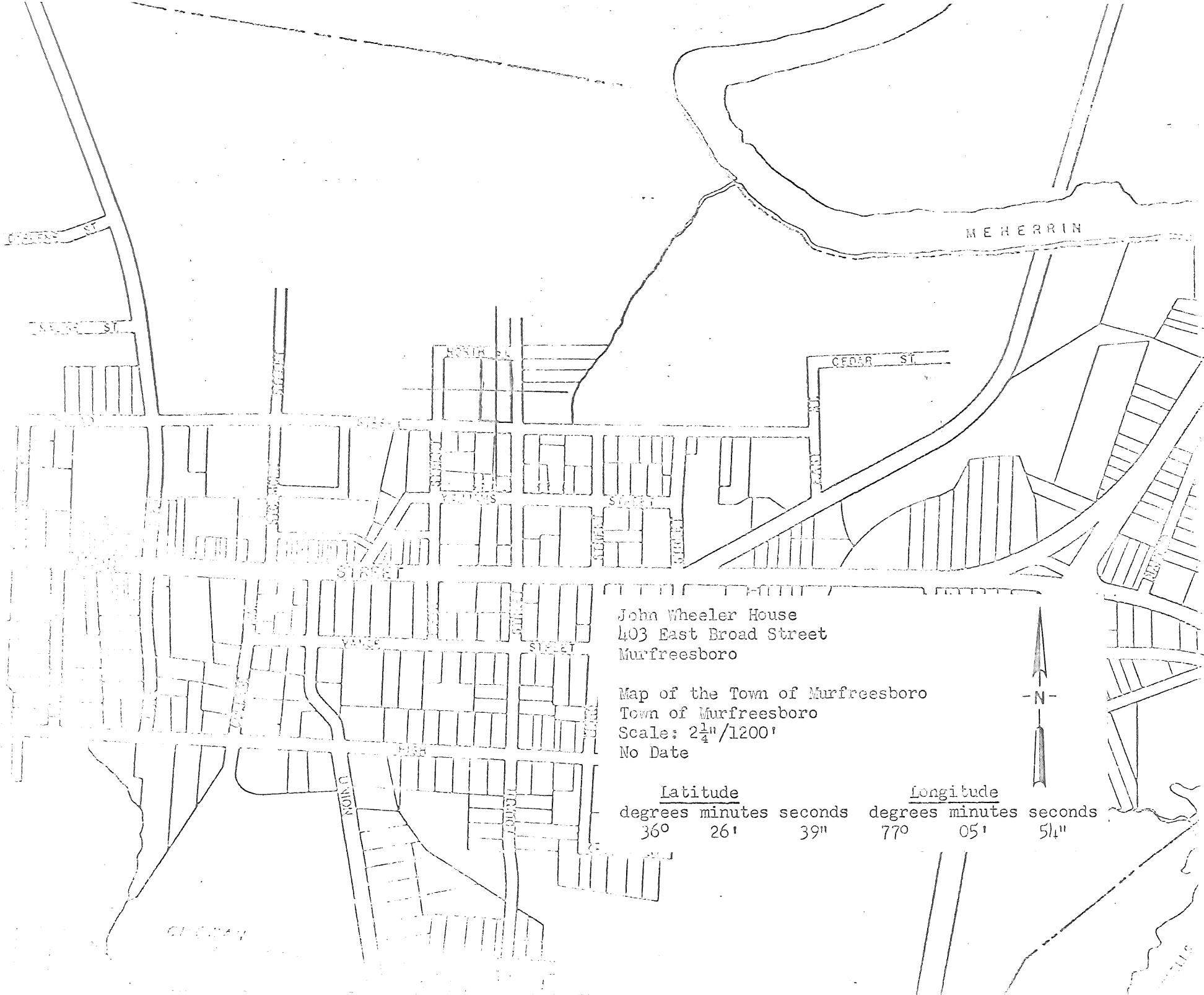

John Wheeler House  
 403 East Broad Street  
 Murfreesboro

Map of the Town of Murfreesboro  
 Town of Murfreesboro  
 Scale:  $2\frac{1}{4}''/1200'$   
 No Date

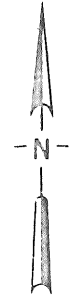

<u>Latitude</u>			<u>Longitude</u>		
degrees	minutes	seconds	degrees	minutes	seconds
36°	26'	39"	77°	05'	54"