

United States Department of the Interior  
National Park Service

# National Register of Historic Places Continuation Sheet

Section number 3-5 Page 1

Rankin-Sherrill House - Additional Documentation  
Rowan County, NC

## Additional Documentation -

### 3. State/Federal Agency Certification

As the designated authority under the National Historic Preservation Act, as amended, I hereby certify that this  nomination  request for determination of eligibility meets the documentation standards for registering properties in the National Register of Historic Places and meets the procedural and professional requirements set for in 36 CFR Part 60. In my opinion, the property  meets  does not meet the National Register criteria. I recommend that this property be considered significant  nationally  statewide  locally. (See continuation sheet for additional comments.)

Gary Brown SHPO 7/22/09  
 Signature of certifying official/Title Date  
 North Carolina Department of Cultural Resources  
 State or Federal agency and bureau

In my opinion, the property  meets  does not meet the National Register criteria. ( See Continuation sheet for additional comments.)

\_\_\_\_\_  
 Signature of certifying official/Title Date  
 \_\_\_\_\_  
 State or Federal agency and bureau

### 4. National Park Service Certification

I hereby certify that the property is: <input type="checkbox"/> entered in the National Register. <input type="checkbox"/> See continuation sheet <input type="checkbox"/> determined eligible for the National Register. <input type="checkbox"/> See continuation sheet <input type="checkbox"/> determined not eligible for the National Register. <input type="checkbox"/> removed from the National Register. <input type="checkbox"/> other, (explain:) _____ _____ _____	Signature of the Keeper _____ _____ _____ _____	Date of Action _____ _____ _____ _____
--	---	--

### 5.

<input type="checkbox"/> building(s)	Contributing	Noncontributing	
<input checked="" type="checkbox"/> district	1	6	buildings
<input type="checkbox"/> site	0	0	sites
<input type="checkbox"/> structure	1	12	structures
<input type="checkbox"/> object	0	0	objects
	2	18	Total

United States Department of the Interior  
National Park Service

## National Register of Historic Places Continuation Sheet

Section number 7 Page 2 Rankin-Sherrill House - Additional Documentation  
Rowan County, NC

### 7. Narrative Description

The following resources stood on several parcels which composed the 7.34 acres originally nominated in 1982 in conjunction with the Rankin-Sherrill House. Section 7 of that nomination provided a physical description solely for the Rankin-Sherrill House. This additional documentation corrects the omission of these resources found within the nominated area at that time. Of these additional resources, only the Rankin-Sherrill House, its smokehouse/dairy/well house, the John and Anita Sherrill House, and its garage stand today. A recently reconstructed concrete block barn stands in the same location to the south of the Rankin-Sherrill House as the original ca. 1940 barn. The earlier barn was torn down after severe damage caused by Hurricane Hugo in 1989.

Smokehouse/Dairy/Well House ca. 1853 Contributing Building

One-story weatherboarded outbuilding with an east facing engaged front gable porch. The building is divided into a smokehouse in the north half of the building with an entry to the east; a dairy at the west end of the south half of the building with an entry facing south; and an open southeast corner sheltering the well. The roof is metal and the foundation is brick.

Barn ca. 1940 Noncontributing Building

Located on a separate parcel to the south of the Rankin-Sherrill House, this one-story concrete block barn has a front gable metal-sheathed roof and weatherboarded gables. The central passage runs north to south and is flanked by stalls. A hay loft is located on the upper floor.

Pole Barn ca. 1940 Noncontributing Structure

On a separate parcel across Mt. Ullah Road (now Centenary Church Road) to the east of the Rankin-Sherrill House, stands a long one-story barn with a metal-sheathed shed roof supported by diagonally braced skinned tree trunk poles.

Storage Building ca. 1940 Noncontributing Building

This one-story brick building is located on a separate parcel to the south of the pole barn. Its side-gable roof is sheathed with metal. Equipment can be driven into the building through a sliding door centered on the rear (east) elevation. An entry door is centered on the façade and a single window is located on the gable ends.

United States Department of the Interior  
National Park Service

## National Register of Historic Places Continuation Sheet

Section number 7 Page 3 Rankin-Sherrill House - Additional Documentation  
Rowan County, NC

---

Grain Bin ca. 1940 Noncontributing Structure

This short, round, metal grain bin is located to the south of the brick storage building.

J. C. Sherrill's Grocery ca. 1924 Noncontributing Building

On a lot at the southwest corner of the intersection of Sherrill's Ford Road and Mt. Ullah Road stands a two-story brick store building with a flat parapet roof on the façade and parapet walls that step down to the rear (south) on the side elevations. An intact angled and recessed storefront with a double-leaf entry is sheltered by a metal-sheathed shed roof canopy. Two gas pumps are located at the north edge of the canopy. A one-story shed roof brick addition runs along the rear half of the west elevation.

John and Anita Sherrill House 1938 Noncontributing Building

This two-story Colonial Revival-style brick house stands to the west of the Rankin-Sherrill House and was built to replace a ca. 1920 frame bungalow built by Price Elias Sherrill and occupied by John and Anita Sherrill from 1931 until 1936 when the house was destroyed by fire. The Sherrill House has a classical one-story entry porch, tall hip roof sheathed with asphalt shingles, six over six sash windows and a one-story sunroom on its east elevation.

Garage ca. 1920 Noncontributing Building

This one-story weatherboarded garage located on a separate parcel to the west of the Sherrill House was built by Price Elias Sherrill at about the same time as the contemporary bungalow destroyed by fire in 1936. The hip roof is sheathed with metal and its two open bays face north. John and Anita Sherrill continued to use the garage after the construction of their 1938 brick house.

Mt. Ullah Mill ca. 1948 Noncontributing Building

Located on the north side of Sherrill's Ford Road across from J. C. Sherrill's Grocery, this five-story-on-basement brick grist mill has a flat roof, metal frame industrial windows and a main entrance at the east end of the south façade at ground level and sheltered by a bracketed shed roof canopy. A one-story metal-sheathed shed roof brick wing on the main block's west elevation contains offices at its south end and an open loading dock to the north running along a flat roof two-story-on-basement brick wing at the north end of the main block. A later metal one-story shed addition is located at the north end of the east elevation.

United States Department of the Interior  
National Park Service

# National Register of Historic Places Continuation Sheet

Section number 7 Page 4 Rankin-Sherrill House - Additional Documentation  
Rowan County, NC

---

Grain Silos (Ten) ca. 1948 Noncontributing Structures

A tightly spaced group of ten concrete three-story grain silos are located to the east of the main mill with little setback from Sherrill's Ford Road.

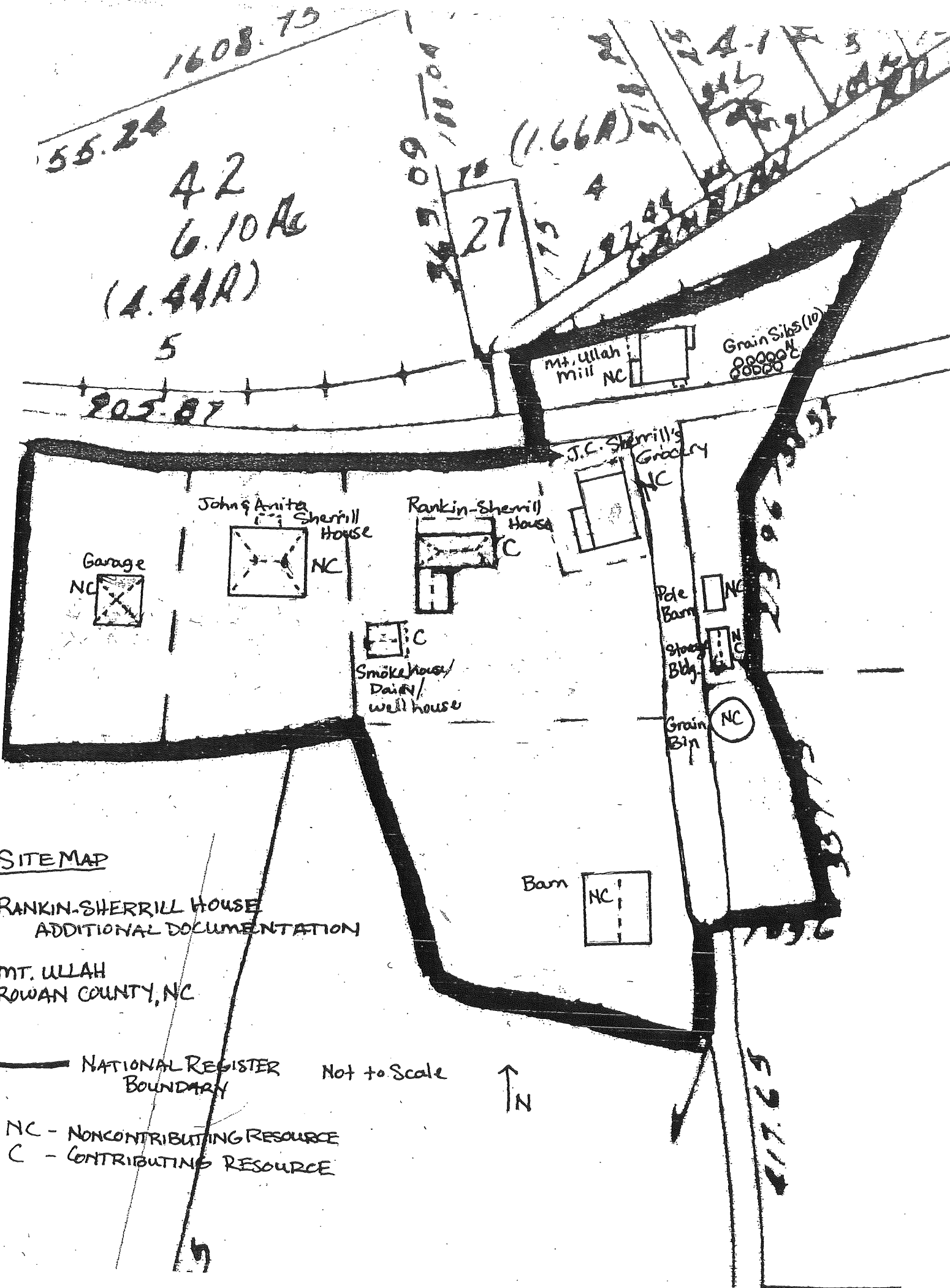

SITE MAP

RANKIN-SHERRILL HOUSE  
 ADDITIONAL DOCUMENTATION

MT. ULLAH  
 ROWAN COUNTY, NC

— NATIONAL REGISTER BOUNDARY Not to Scale

NC - NONCONTRIBUTING RESOURCE  
 C - CONTRIBUTING RESOURCE